

251.02/N

Für Luft, Wasser, Öl, Dampf etc.

Betriebstemperatur: max. 150 °C  
 max. 80 °C (mit NBR-O-Ring)

Druck: max. 60 bar

### Reduziernippel

Artikel Nr.	Ident Nr.	Außen- gewinde F	Innen- gewinde F1	Ch mm	P mm	L mm
251.00/N	111330	G 1/8	M5	14	6,0	10,5
251.01/N	111331	G 1/4	G 1/8	17	8,0	13,0
251.06/N	111332	G 3/8	G 1/8	20	9,0	14,0
251.02/N	101040	G 3/8	G 1/4	20	9,0	14,0
251.08/N	111333	G 1/2	G 1/8	24	10,0	15,5
251.07/N	111334	G 1/2	G 1/4	25	10,0	15,5
251.03/N	111335	G 1/2	G 3/8	25	10,0	15,5
251.09/N	111336	G 3/4	G 3/8	30	11,0	17,5
251.10/N	111337	G 3/4	G 1/2	30	11,0	17,5
251.11/N	111338	G 1	G 1/2	36	12,0	19,0
251.12/N	111339	G 1	G 3/4	36	11,5	19,0

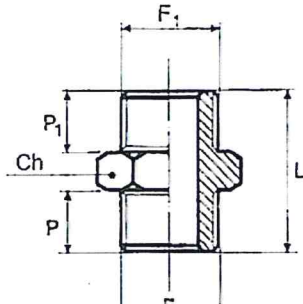

252.62

**Doppelgewindenippel, Außengewinde zylindrisch**

Artikel Nr.	Ident Nr.	Gewinde 1 F	Gewinde 2 F1	Ch mm	P mm	P1 mm	L mm
252.31	111350	M5	M5	8	4,0	4,0	11,5
252.32	111351	M5	G 1/8	14	4,0	6,0	14,5
252.33	111352	G 1/8	G 1/8	14	6,0	6,0	17,0
252.34	111353	G 1/8	G 1/4	17	6,0	8,0	19,0
252.35	111354	G 1/8	G 3/8	20	6,0	9,0	20,0
252.61	100770	G 1/4	G 1/4	17	8,0	8,0	21,0
252.62	111355	G 1/4	G 3/8	20	8,0	9,0	22,0
252.63	111356	G 1/4	G 1/2	25	8,0	10,0	24,0
252.64	100834	G 3/8	G 3/8	20	9,0	9,0	24,0
252.65	111357	G 3/8	G 1/2	25	9,0	10,0	25,5
252.65-1	111358	G 3/8	G 3/4	27	9,0	12,0	27,0
252.66	100838	G 1/2	G 1/2	25	10,0	10,0	26,5
252.67	111359	G 1/2	G 3/4	30	10,0	11,0	27,5
252.67-1	111360	G 1/2	G 1	34	10,5	15,0	32,5
252.68	111361	G 3/4	G 1	36	12,0	11,0	30,0
252.69	111362	G 3/4	G 3/4	30	11,0	11,0	28,0
252.70	111363	G 1	G 1	36	12,0	12,0	31,0
252.71	111364	G 1	G 1 1/4	43	15,0	16,0	38,0
252.71-1	111365	G 1	G 1 1/2	50	15,0	16,0	38,5
252.71-2	111366	G 1	G 2	60	15,0	18,0	42,0
252.72	111367	G 1 1/4	G 1 1/4	42	16,0	16,0	39,0
252.72-1	111368	G 1 1/4	G 1 1/2	50	16,0	16,0	40,0
252.72-2	111369	G 1 1/4	G 2	60	16,0	18,0	43,0
252.73	111370	G 1 1/2	G 1 1/2	50	16,0	16,0	39,5
252.73-1	111371	G 1 1/2	G 2	60	17,5	18,0	44,5
252.74	111372	G 2	G 2	60	17,5	17,5	44,0
252.74-1	111373	G 2	G 2 1/2	77	19,0	24,0	54,0
252.74-2	111374	G 2	G 3	89	20,0	20,0	50,0
252.74-3	111375	G 2 1/2	G 2 1/2	77	24,0	24,0	59,0
252.74-4	111376	G 2 1/2	G 3	89	22,5	20,0	52,5
252.74-5	111377	G 3	G 3	89	24,5	24,5	60,0